

1. All boundaries, dimensions and levels are to be checked on site before construction and any discrepancies are to be reported to the Architect.
 2. Do not scale from this drawing other than for planning purposes.
 3. Drawings not supplied in paper format by A+G architects Ltd may not be to the scale indicated in the size box.
 4. This drawing is copyright and may not be reproduced or used for any purpose other than that intended without prior written agreement from A+G architects.
 5. Any parts of the drawing based on Ordnance Survey maps are executed with the sanction of the controller of H.M. Stationery Office - Crown Copyright Reserved.

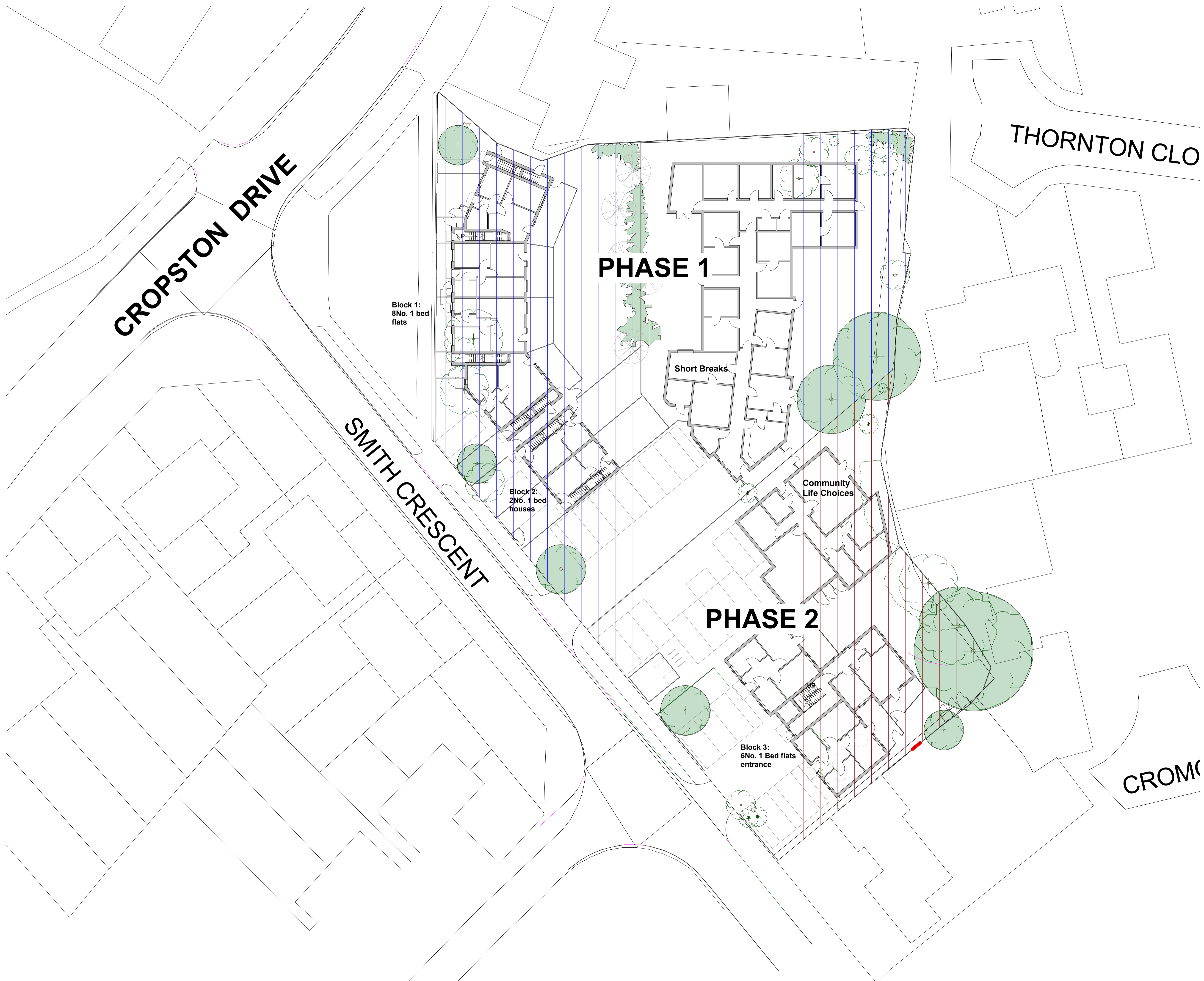

CROPSTON DRIVE

SMITH CRESCENT

THORNTON CLO

CROMWELL

PHASE 1

PHASE 2

Block 1:
8No. 1 bed flats

Block 2:
2No. 1 bed houses

Block 3:
6No. 1 Bed flats entrance

Short Breaks

Community Life Choices

Rev	Date	Description	By	Chk

A+G architects

11 Leicester Road • Loughborough
 Leicestershire • LE11 2AE
 t: 01509 212310
 e: email@aandgarchitects.com
 w: www.aandgarchitects.com

Client:
 Leicestershire County Council
 Fortem

Project:
 Coalville Supported Living
 Smith Crescent
 Leicester

Drawing title:
 Site Phasing

Scales(s)	Size	First issue	Drawn	Checked
1 : 200	A1		Author	Checker

Job no:	Drawing no:	Rev:
L1830	114	

This page is intentionally left blank